

**DRR13/147 Enc. 2 : BROMLEY: OLF Projects Update: November**

**BROMLEY SOUTH**

**Bromley High Street** new stone setts block pavers for opposite station and buff anti-skid treatment for road.  
Implementation: **January**

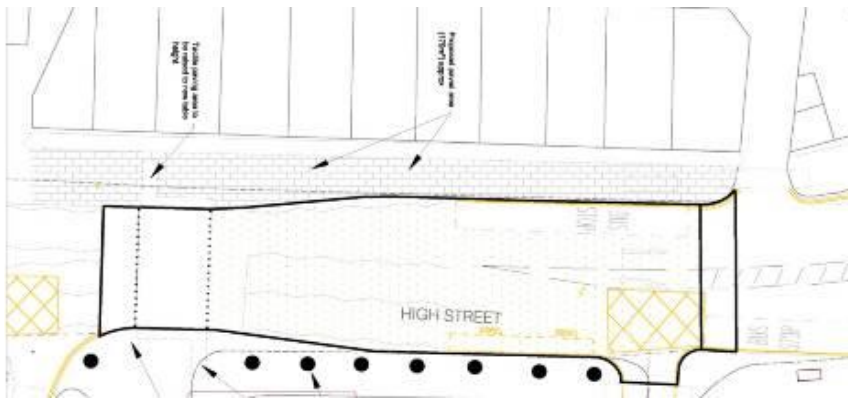

**Waitrose access road layby** – New layby for car drop off and pick up. Implementation **November**

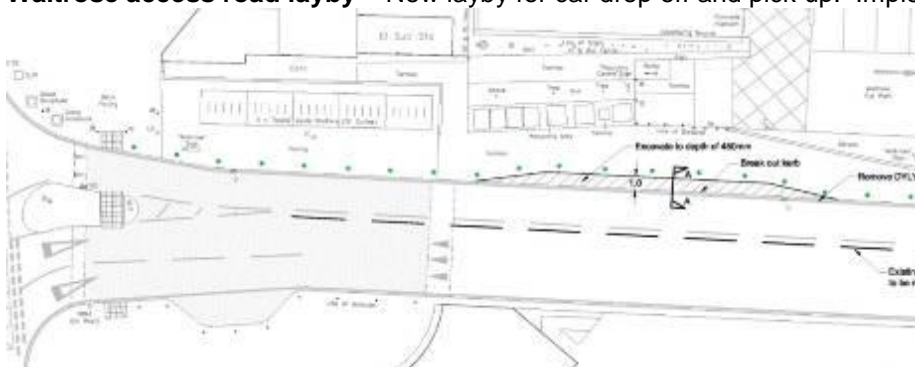

**Westmorland Place sheep pen.** Implementation date **November/December 2014.**

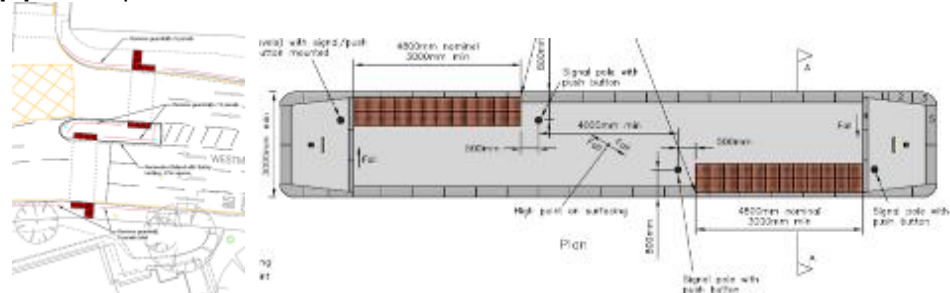

### Countdown Crossing Glades, Elmfield Road Implementation November - December



### Bromley Boulevard of Trees

No. 17 root-ball trees 5m height Risk: Implementation November 2013



### St Marks Church Public Space - Implementation Date: Dec- March 2014





# 1C Shopfronts



Street  
 Block 3 East Street south, 2-6 September- October  
 Block 1 High Street, 216, 218 October - December  
 Block 4 East Street /Market Parade, Jan 2014  
 Block 2-22 High Street Jan- Feb 2014  
 Market Sqaure Zucchi Shoes December (TBC)  
 Independents unit contributions, July –Feb 2014

Units  
 (7 units)  
 (2 units)  
 (1 unit)  
 (6 units)  
 (1 Unit)  
 (7 units) 3 completed



Block 3 East Street (below as well)



Block 4



Market Square Zucchi Shoes



Above: East Street fish and chip shop.  
 Before and after images of Aqua on the right above and below.



### 1D Welcome Strategy

**Bus Shelter Seat:** New bus stops to be added: Risk: Delays in delivering bench before Christmas 2013. Seat under construction. Implementation **mid January**.

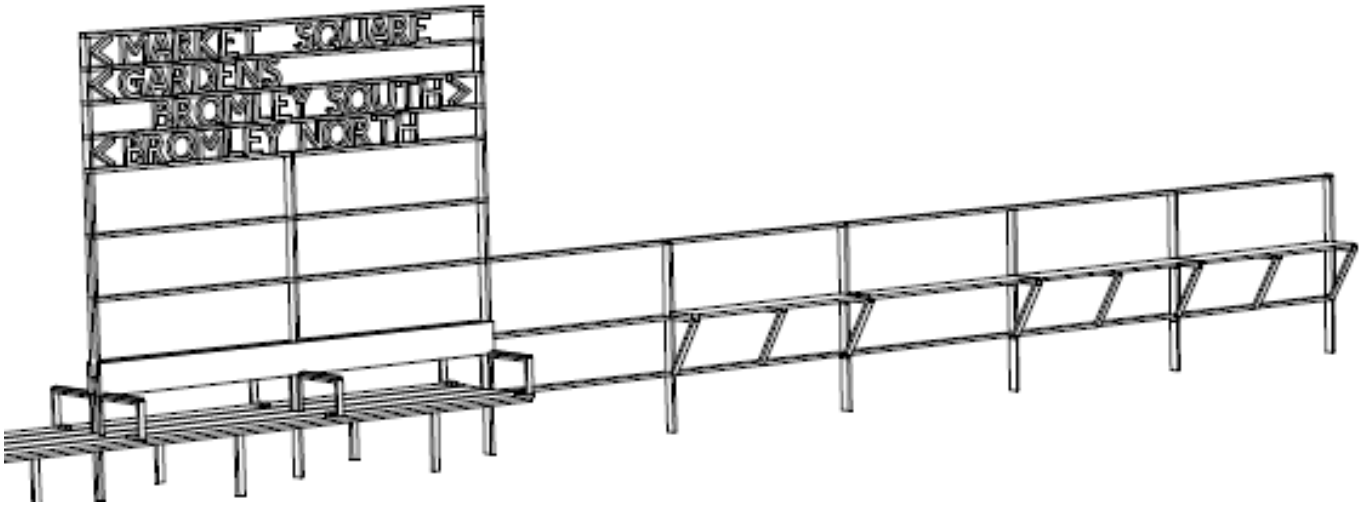

### Lighting the Library and Churchill – Implementation: Mid-January



### 2-22 High Street Sign and shopfronts – Frontage improvement and sign on roof. Implementation: **January – March 2014**

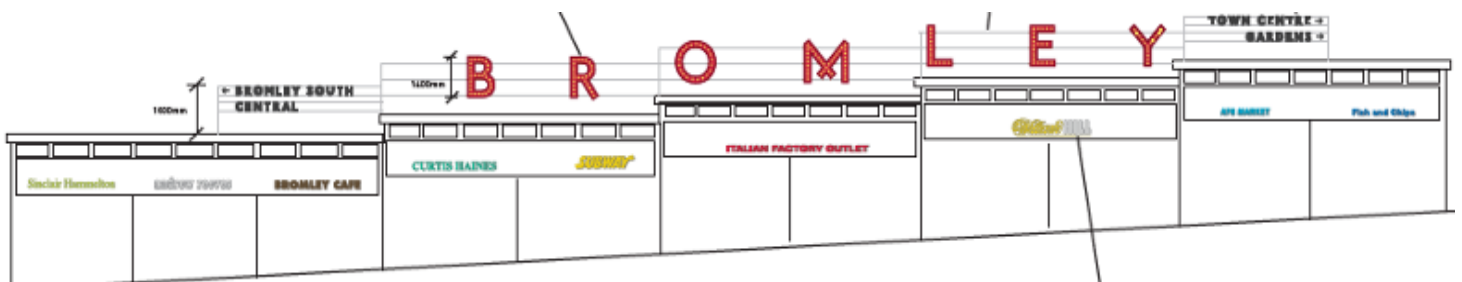



**Legible London:** Map to be finalised, Awaiting final post locations from the 1A team  
Implementation starts: **November**



### **BROMLEY sign on grass opposite Bromley North Station**

Large stainless steel letters, 2 meters high spelling BROMLEY similar to image below:  
Implementation **February -March**



### **Bromley's 'High Street Garden' Success**

- Artificial Grass to be donated to three schools in Bromley in November 2013
- 10 fruity Bean bags to be used by the Library and Theatre for school events
- 10 new bright and cheerful benches to be relocated in the Park, pedestrian spine and Library Gardens



